

notes
 this drawing and design is the copyright of aja architects llp and must not be reproduced in part or in whole without prior written consent. contractors must verify all dimensions on site before commencing work or preparing shop drawings. If in doubt ASK.
 Where this drawing contains any Ordnance Survey mapping material, it has been reproduced under license number 100052278.
 Ordnance Survey © Crown copyright

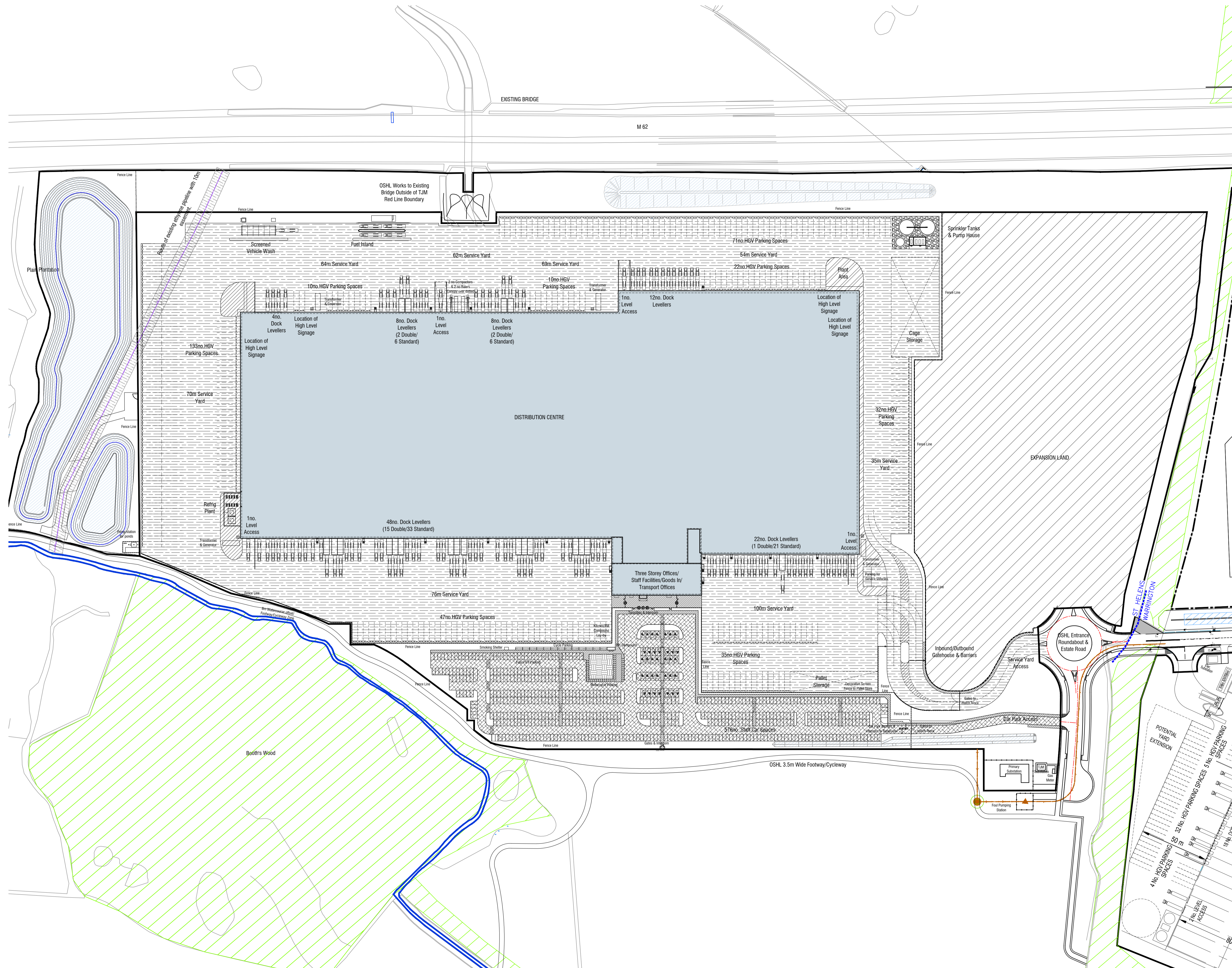

- LEGEND
- BRETT OMEGA STANDARD BLOCK PAVING (COLOUR: BRINDLE)
 - TARMAC TO CAR PARK AREAS
 - BRUSH FINISHED CONCRETE TO SERVICE YARDS
 - GRAVEL FINISH TO SPRINKLERS AND PUMP HOUSE
 - CONCRETE FINISH TO TRAFFIC ISLANDS
 - BRETT OMEGA STANDARD BLOCK PAVING (COLOUR: BUFF)

NOTE
 REFER TO LANDSCAPE ARCHITECTS DRAWINGS FOR SOFT LANDSCAPING AREAS AND ENGINEERS DRAWINGS FOR BUNDS/TRAFFIC ISLANDS DETAILS

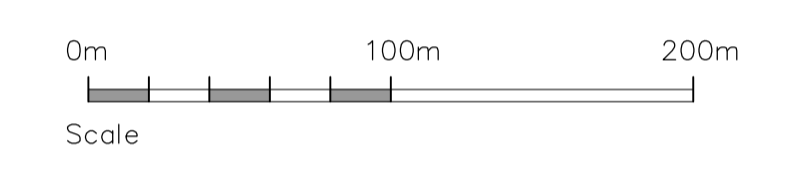

no.	date	revision	by
F	24-06-20	Footway/cycleway updated	spp
E	23-04-20	Smoking Shelter relocated	spp
D	20-04-20	Finishes adjusted in conjunction with changes to site layout	CT
C	21-02-20	Scale Bar added.	rpw
B	20-01-20	Minor amendments	spp
A	18-12-19	Minor amendments	Knf

aja architects llp
 1170 Elliott Court
 Herald Avenue
 Coventry Business Park
 COVENTRY CV5 6UB
 T: 024 7625 3200
 F: 024 7625 3210
 E: aja@aja-architects.com
 W: www.aja-architects.com
 aja architects llp is a limited liability partnership registered in England No. OC326721
 client

Omega St Helens Ltd/
 TJ Morris Ltd

project
 Unit 1
 Omega Zone 8
 St. Helens
 drawing
 Proposed External Finishes Plan
 UNIT 1 DWG 11

scale 1:1250 @ A1 drawn rp
 checked ajps date 10-12-19

no
 6385 - 189 - Rev F